

### Setup & Operating Instructions



### Setting up power: Battery Operation

**1.1** Unscrew the end cap on the battery wand at the end *without* the cable protruding.

**1.2** Insert 8 x AA Lithium-ion batteries in to the battery wand – check that they are pointing in the correct direction as shown on the side of the wand.

**IMPORTANT:** Do not mix type/brand or old batteries with new for replacement batteries.

**1.3** Screw back end cap back on and connect the 2-pin cable plug at the other end of the wand into the plug from the wire protruding out of the blind headrail (Fig 1). The power is now connected.

AA x8

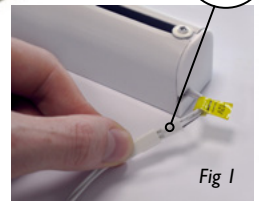

**TIP:** Mount the battery wand to the wall using the brackets provided. Place the rubber band beside the bracket to stop it moving.



# Setting up power: Mains Operation

- 1.4 Connect the relevant mains adaptor plug front to the transformer by twisting into position (as shown below)
- 1.5 Connect the 2-pin cable plug into the wire protruding out of the blind headrail (Fig 1). The power is now connected.

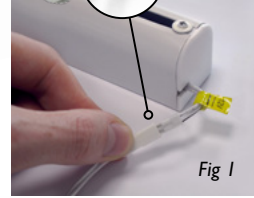
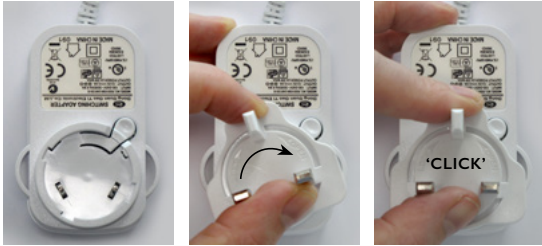

## Pairing your remote



**IMPORTANT:** Only use 1 single channel remote for this programming procedure.

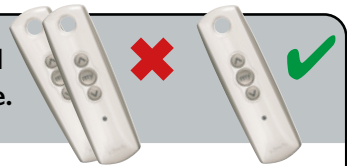

### 1 First reset the main headrail motor:

Ensure that there is power running to the main headrail. Now locate the motor **reset button** which is in a small hole within the headrail channel on the silver coloured motor close to the wiring end. Using a paperclip or a thin watchmaker's screwdriver press-and-hold-down the **reset button** for **2-3 Secs** until the headrail motor jogs, then release.

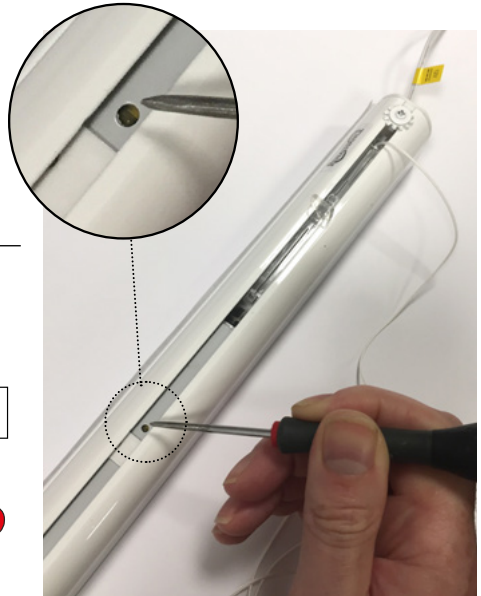

### 2 Now pair your remote:

Find the **Program Store Button** on the reverse of your single channel remote handset and press with a thin watchmaker's screwdriver or a paperclip until the headrail motor jogs, then release.

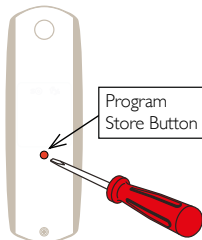

**Your remote is now PAIRED!**

# Programming your remote continued

## 3 Reverse the direction

3.1 To reverse the direction of the motor, press and hold the **my** button until the blind shuts.

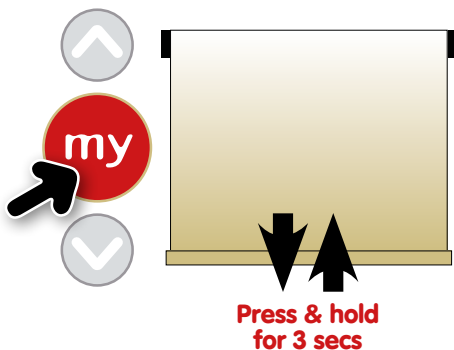

3.2 Press and hold the DOWN button to test that the motor direction is correct.

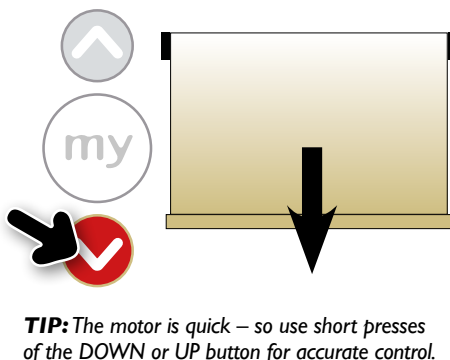

## 4 Set your upper limit position

4.1 Press and hold the UP button to move the blind until it reaches your desired upper limit position – should you go too far and need to adjust back down then simply press the down button until you reach the upper limit position.

**IMPORTANT:** Please read and understand both steps 4.2 and 4.3 before progressing!

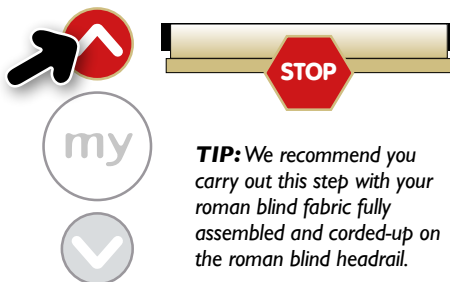

4.2 Press and hold the **my** and DOWN buttons together until the blind starts to automatically move down (it will run until you complete the next step – so be prepared to stop at desired lower position).

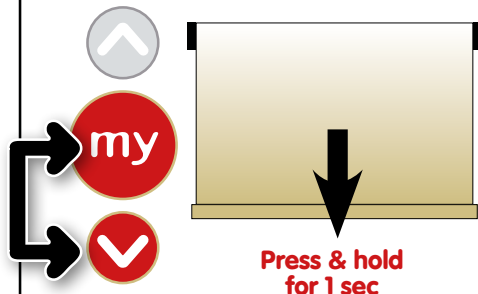

4.3 To stop the blind at the desired lower limit position briefly press the **my** button (adjust with Up or Down if required).

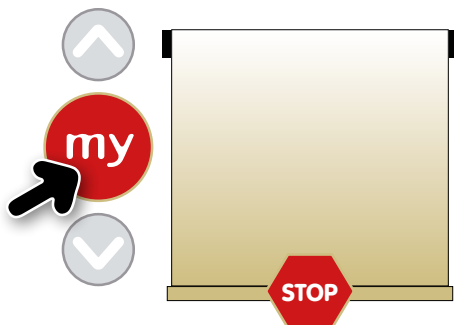

## Programming your remote continued

### 5 Set your *lower limit position*

5.1 Press and hold the **my** and Up button until the blind starts to move up.

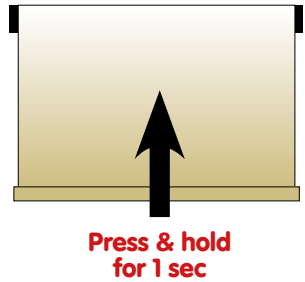

5.2 The blind will now automatically stop at your previously chosen Upper limit position.



5.3 Press and hold the **my** button until the blind shunts to confirm the limit settings.



### 6 You MUST lock your settings

**IMPORTANT:** This step must be completed or your batteries will drain

Press and hold in the Program Store Button on the reverse of the handheld remote until the product shunts once. This completes the handset programming.

**TIP:** A thin watchmaker's screwdriver or a paperclip would be suitable for this step.

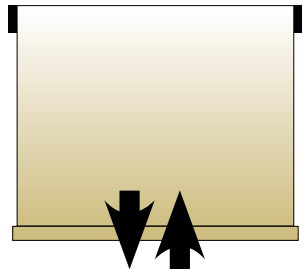
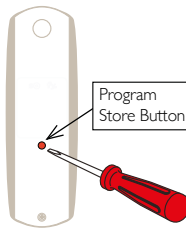

**IMPORTANT:** Only use one single channel remote for this programming procedure.



# Changing your saved settings

## 7 Adjusting the lower limit position

7.1 Press the Down button and send the blind to the current-set lower limit position

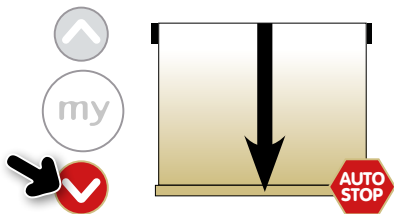

7.2 Press and hold the Up and Down buttons until the blind shunts.



7.3 Adjust to the desired new position by using either the Up or Down buttons

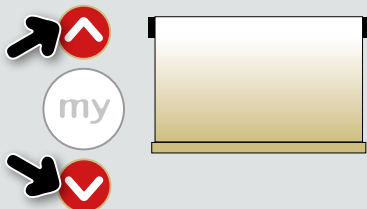

7.4 Press and hold the **my** button until the blind shunts – the new upper limit will now be set.

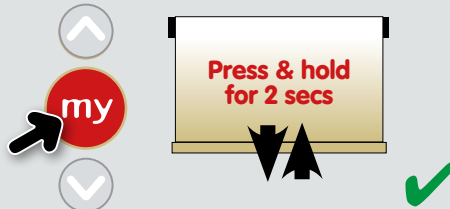

## 8 Adjusting the upper limit position

8.1 Press the Up button and send the blind to the current-set upper limit position

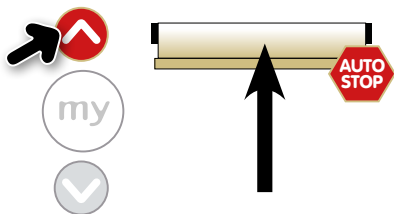

8.2 Press and hold the Up and Down buttons until the blind shunts.

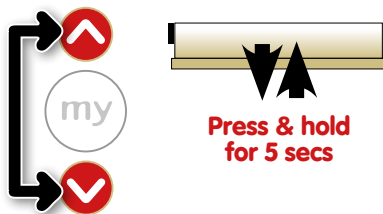

8.3 Adjust to the desired new position by using either the Up or Down buttons

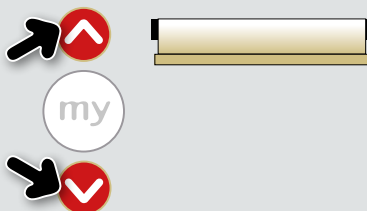

8.4 Press and hold the **my** button until the blind shunts – the new lower limit will now be set.

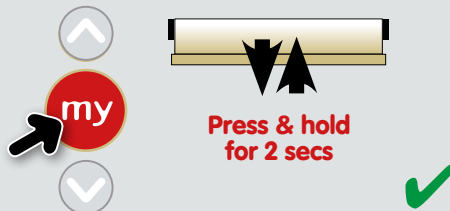

## Using your remote control and my settings

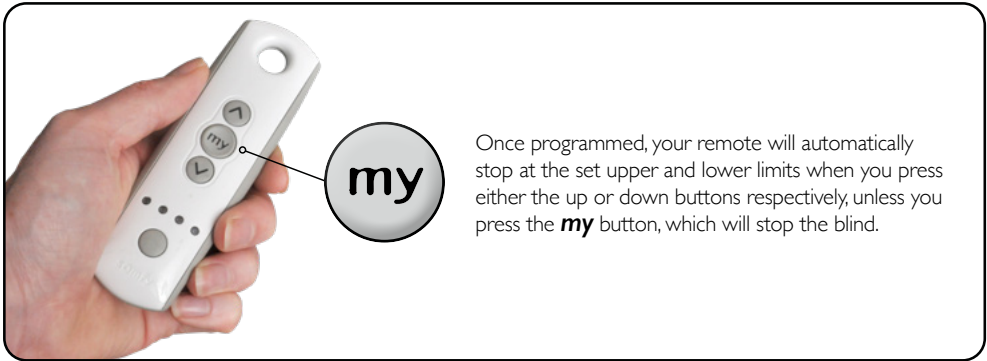

## How to programme a Multi-Channel remote

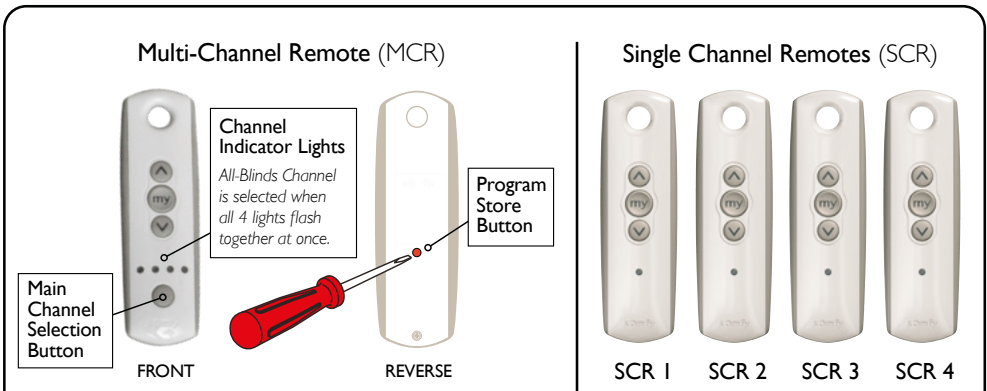

**IMPORTANT:** Ensure that each blind you wish to operate has been fully programmed and set with upper and lower limit stop positions of your choice with it's own individual single channel remote

If not, then follow the steps shown on the previous pages under 'Setting up and programming your remote' to get to this point.

Each Single-Channel Remote's preset programme for each individual blind will be copied to a specific channel(s) of your choice on the Multi-Channel Remote (It is possible for a single channel to operate 2 blinds at the same time).

**NOTE:** Only the blind being programmed should be connected to the Power during the programming process

### Multi-Channel Remote

Available separately.



# How to programme a Multi-Channel remote continued

To program a Multi-Channel Remote (MCR) you are going to copy the programming from each Single Channel Remote (SCR) onto the relevant channel of your choice on the MCR.

**NOTE:** Only one blind can be copied at a time so all other blinds should remain disconnected from their power supply during the copying process.

## 9 To 'Copy & Paste' a programme from an SCR to the MCR

**9.1** First, connect your blind to the power and disconnect all other blinds.

**9.2** To 'Copy' a programme press the Program Store Button (on the reverse of the SCR handset of your selected blind). The Blind will jog once – it is now copied and ready to be pasted.

**9.3** To 'Paste' this copied programme, first select the channel of your choice on the MCR by pressing the Main Channel Selection Button – each press of the button will highlight a chosen

indicator channel which will flash green on the MCR handset. Keep pressing until the channel you require is flashing. *NOTE: When all lights flash this is the All-Blinds Channel – don't use this channel yet.*

**9.4** When your chosen channel is flashing press the Program Store Button (on the reverse of the MCR remote handset). The blind should 'jog' once to show that the programme has now been pasted successfully to your chosen channel.

**9.5** If you want to have an 'All-Blinds' Channel to control all the blinds at once, you **must** now copy the same blind onto the channel (see step 10).

## 10 'Pasting' to the All-Blinds Channel

**10.1** Firstly, select the channel you have just copied your current programme to on the MCR.

**10.2** When your chosen channel is flashing press the Program Store Button (on the reverse of the MCR remote handset). The blind should jog once to show that the programme has now copied and ready to be pasted.

**10.3** Press the Main Channel Selection Button until all 4 indicator lights are flash to show that the All-Blinds Channel is selected.

**10.4** Now press the Program Store Button (on the reverse of the MCR remote handset). The blind should 'jog' once again to show that the programme has now been pasted successfully to the All-Blinds Channel.

**IMPORTANT:** We recommend that you now try both new channels to confirm the settings and programmes have been copied and stored correctly before moving onto the next SCR to be copied over.

## 11 Repeat the process for your remaining SCR blind programmes

**11.1** Follow Steps 9 and 10 for each of your SCR programmes to copy and paste them onto the MCR. Make sure that you select a different channel for each SCR on your MCR each time for Step 9 and ensure you remember to copy each SCR programme to the All-Blinds Channel too.

**REMEMBER:** Disconnect the power to the blinds once they have been copied and pasted onto the MCR before repeating the process for the next SCR. Only the blind you are copying should be connected to the power supply at any one time.

**NOTE:** You can paste more than one blind programme to a channel on the MCR. Each channel can operate up to 2 blinds at once.

# Resetting your blind/Restoring to factory default



**IMPORTANT:** This step can erase all memory or any previously recorded settings! Ensure you follow this procedure carefully

Locate the motor **reset button** which is in a small hole within the headrail channel on the silver coloured motor close to the wiring end. Using a paperclip or a thin watchmaker's screwdriver press-and-hold-down the **reset button** for up to **12 Secs** for all 3 jogs (release at desired jog as shown below)

## Release the program button after:

**1 jog** – followed by pressing the programming button on a handset, wall switch or sensor adds the control to the motor.

**2 jogs** – deleted all controls (end limits remain).

**3 jogs** – results in a complete factory reset.

**IMPORTANT:** All handheld remote control settings linked with the roman blind headrail will be deleted along with the limit programming and any sensors that have been programmed.

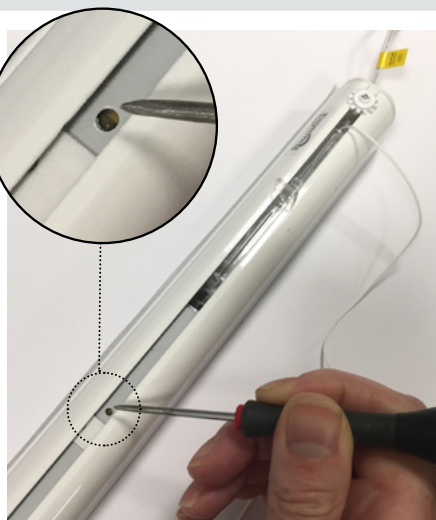

**Press & hold  
for 2 secs**



**After 1 jog**

...followed by pressing 'program store' button on a handset adds the control to the motor.

**Press & hold  
for 7 secs**



**After 2 jogs**

All controls deleted (but end limits remain)

**Press & hold  
for 12 secs**



**After 3 jogs**

Motor has been reset to factory default



## Your remote control wall hook

Each handheld remote comes with a handy wall hook. To install, simply drill a hole at desired position and screw in the metal screw-adapter provided. Finally screw your hook in place until firm and secure.

**TIP:** Always wear the correct safety goggles if drilling.

